

EAD OPEN TYPE

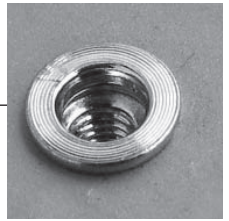

EAD-FICHE

For installation information please refer to the tooling overview and manuals on our website www.scell-it.com
 Pour les conditions de pose, merci de vous référer à la description de l'outil et aux manuels disponibles sur notre site web.
 Angaben zur Verarbeitung entnehmen Sie bitte der Geräteübersicht und den Betriebsanleitungen auf unserer Website.
 Pro informace ohledně montáže navštivte naše webové stránky nebo nahlédněte do manuálu k nářadí.

ENGLISH	FRANÇAIS	DEUTSCH	CZECH
Insert / Knurled	Ecrou / Cranté	Einnietmutter / Gerillt	nýtovací matice / s rýhovaným dřikem
Cylindrical head	Tête plate	Flachrundkopf	plochá hlava
Aluminium	Aluminium	Aluminium	hliník

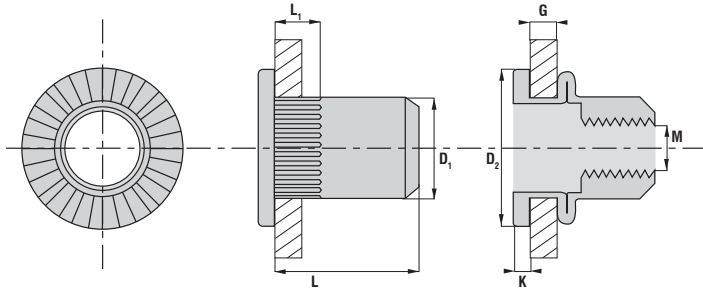

PART NO/REF	M	D1	D2	K	L	L1	G
	Ø (mm)	Ø (mm)	Ø (mm)	(mm)	(mm)	(mm)	(mm)
EAD0330	M3	4.9	7.0	1.0	10.0	4.0	0.5 - 2.5
EAD0430	M4	5.9	9.0	1.1	12.0	4.4	0.3 - 3.0
EAD0440	M4	5.9	9.0	1.1	12.0	6.4	3.0 - 4.5
EAD0530	M5	6.9	10.0	1.1	12.0	4.9	0.3 - 3.0
EAD0540	M5	6.9	10.0	1.1	15.5	6.9	3.0 - 5.0
EAD0630	M6	8.9	13.0	1.6	14.5	6.4	0.5 - 3.0
EAD0645	M6	8.9	13.0	1.6	17.0	8.4	3.0 - 5.5
EAD0830	M8	10.9	16.0	1.6	16.0	6.9	0.5 - 3.0
EAD0855	M8	10.9	16.0	1.6	18.5	9.4	3.0 - 5.5
EAD1030	M10	12.9	19.0	2.1	17.0	7.9	0.5 - 3.0
EAD1060	M10	12.9	19.0	2.1	22.0	9.9	3.0 - 6.0
EAD1240	M12	15.9	23.0	2.1	25.0	9.9	1.0 - 4.0

	DRILLING	RECOMMENDED MAX TORQUE	PULL-OUT	SHEAR
M	(mm)	(Nm)	(N)	(N)
M3	5.0	3.5	2 100	1 000
M4	6.0	4.0	2 900	1 100
M5	7.0	5.0	5 000	1 200
M6	9.0	11.3	9 400	2 300
M8	11.0	14.6	14 000	2 500
M10	13.0	19.9	19 900	3 500
M12	16.0	26.5	28 000	4 900

UNIT PLANT CERTIFICATES



Scell-it®
 Engineering & Development

© 2009 Blue future Intellectual Properties

Data shown are subject to change without prior notice as a result of continuous product development and improvement policy.
 Your local Scell-it representative is at your disposal should you need to confirm latest information.